

T-SLOT CUTTERS

Our standard product programme for T-slot cutters covers already a huge variety of different outside diameters and widths in HSS-E and carbide. Due to the tapered neck diameter, a deep depth of slot can be achieved. The cutting edge can be chamfered or rounded with a radius on request.



STANDARD CUTTERS - HSS-E / VHM

- Dimensions: Outside diameter 1,1- 35 mm, with parallel shank h6
- Clamping: With or without clamping flat
- Form: Width hollow ground
- Gearing: Straight toothed, 3-20 flutes
- Type: Relief-ground

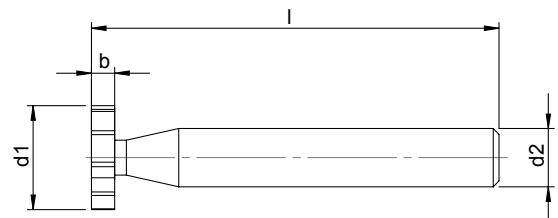

Outside-Ø d1 (mm)	Width b (mm)	Taper (Ø x mm)	Flutes	Shank-Ø d2 (mm)	Total length l (mm)	VHM Art. No.	HSS-E Art. No.
1,1	0,3-1,5	0,7 x 1,5	3	3	32	51090	52090
1,5	0,3-1,5	0,9 x 2	5	3	32	51100	52100
1,6	0,3-1,5	0,9 x 2	5	3	32	51110	52110
1,7	0,3-1,5	0,9 x 2	5	3	32	51120	52120
2	0,3-1,5	1,2 x 2	5	3	32	51130	52130
2,1	0,3-1,5	1,2 x 2	5	3	32	51140	52140
2,2	0,3-1,5	1,2 x 2	5	3	32	51150	52150
2,5	0,3-2,0	1,2 x 3	5	3	32	51160	52160
2,7	0,3-2,0	1,2 x 3	5	3	32	51170	52170
3,0	0,3-2,0	1,7 x 3	5	3	32	51180	52180
3,1	0,3-2,0	1,7 x 3	5	4	32	51190	52190
3,4	0,3-2,0	1,7 x 3	5	4	32	51200	52200
3,5	0,5-2,0	2 x 3	5	4	32	51210	52210
4	0,5-2,0	2,5 x 3	5	4	38	51220	52220
4,2	0,5-2,0	2,5 x 3	5	5	38	51230	52230
4,5	0,5-2,0	2,5 x 3	6	5	38	51240	52240
5	0,5-2,0	2,5 x 3	6	5	38	51250	52250
6	0,5-2,0	2,5 x 3	6	6	50	51260	52260
8	0,5-3,0	2,5 x 3	8	8	50	51270	52270
10	0,5-3,0	3,5 x 5	10	10	70	51280	52280
12	0,5-4,0	3,5 x 5	10	10	70	51290	52290
15	0,5-5,0	5 x 6	12	10	70	51300	52300
16	0,5-6,0	5 x 6	12	10	70	51310	52310
18	0,5-6,0	6 x 8	12	10	70	51320	52320
20	0,5-6,0	6 x 8	12	10	70	51330	52330
25	0,5-8,0	8 x 8	16	10	70	51340	52340
30	1,0-8,0	8 x 8	16	10	70	51350	52350
35	1,0-8,0	10 x 8	20	10	70	51360	52360

✓ Standard version. Please indicate width, article-no. and Clamping (with or without clamping flat) when you place your order.

SPECIAL DESIGN

- Material: HSS-E / VHM
- Dimensions: Design according to feasibility and customer requirement
- Form: According to sample, drawing or work piece drawing
- Clamping: With or without clamping flat
- Gearing: Straight-, helical- or staggered toothed

