

RADIUS FORM END MILLS - CONVEX

Due to their sideway hollow grinding and their tapered neck diameter, radius form end mills are suitable for deep slots and for different radius widths. They are available in HSS-E and carbide.



STANDARD CUTTERS - HSS-E / VHM

- Dimensions: Outside diameter 6 - 25 mm, with parallel shank h6
- Clamping: With or without clamping flat
- Gearing: Straight toothed
- Form: Frontal hollow ground
- Type: Relief-ground (VHM) / relief-turned (HSS-E)

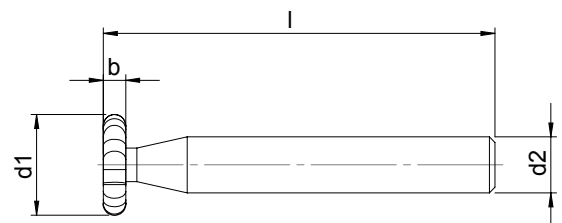

| Outside-Ø d1 (mm) | Cutting edge width b (mm) | Taper (Ø x mm) | Flutes | Shank-Ø d2 (mm) | Length l (mm) | VHM Art. No. | HSS-E Art. No. |
|-------------------|---------------------------|----------------|--------|-----------------|---------------|--------------|----------------|
| 6 | 0,5 - 2,0 | 2,5 x 3 | 6 | 6 | 50 | 53090 | 54090 |
| 8 | 0,5 - 3,0 | 2,5 x 3 | 6 | 8 | 50 | 53110 | 54110 |
| 10 | 0,5 - 3,0 | 3,5 x 5 | 8 | 10 | 70 | 53130 | 54130 |
| 12 | 1,0 - 4,0 | 3,5 x 5 | 8 | 10 | 70 | 53150 | 54150 |
| 15 | 1,0 - 5,0 | 5 x 6 | 8 - 10 | 10 | 70 | 53170 | 54170 |
| 16 | 1,0 - 6,0 | 5 x 6 | 8 - 10 | 10 | 70 | 53190 | 54190 |
| 18 | 1,0 - 6,0 | 6 x 8 | 8 - 10 | 10 | 70 | 53210 | 54210 |
| 20 | 1,0 - 6,0 | 6 x 8 | 8 - 10 | 10 | 70 | 53230 | 54230 |
| 25 | 2,0 - 8,0 | 6 x 8 | 8 - 12 | 10 | 70 | 53250 | 54250 |
| 25 | 3,0 - 10,0 | 8 x 8 | 8 - 12 | 10 | 70 | 53270 | 54270 |

✓ Standard version. Please indicate article-no, width of edge and Clamping (with or without clamping flat) when you place your order.

x Technical producibility is checked on request.

SPECIAL DESIGN

- Material : HSS-E / VHM
- Dimensions: Design according to feasibility and customer requirement
- Form: According to sample, drawing or work piece drawing
- Clamping: With or without clamping flat
- Gearing: Straight toothed

